

# Video Intercom Systems User Guide and System Instructions

## Getting Started

Congratulations on your new Video Intercom System! we are proud to provide secure, reliable entry solutions for your home or business. This user manual will provide answers for any operational questions you may encounter throughout your system's lifetime.

## Door Entry

The outdoor panel for your system has been installed and programmed to ring your unit when the corresponding button is pressed. If your panel is equipped with an RF Card Reader, swipe the card/key-fob across the reader and the door will unlock.

## Video Monitor Functions

The indoor room station has four illuminated buttons on the face and three scrolling adjusters on the edge to control Brightness, Color, and Volume.

The blue illuminated buttons from left to right are **Monitor**, **Alarm**, **Unlock**, and **Talk/Listen**.

To answer an incoming call, press **Talk** to answer, then speak freely. Calls last for 60 seconds - you DO NOT have to hold talk to enable voice communication. Press talk again to end the conversation. To **Unlock** the door, press the unlock button during a call and the door should release to allow entry.

Press **Monitor** button while in standby mode and you will be able to view the outdoor station camera. If there is an additional surveillance camera, press **Monitor** button again to switch modes. Press **Talk** twice to exit.

To change the Ringtone, press and hold Talk until you hear your current ringtone, then **Alarm** or **Monitor** to cycle through the different tones, then press **Talk** to save. There are **6** ring tones to choose.

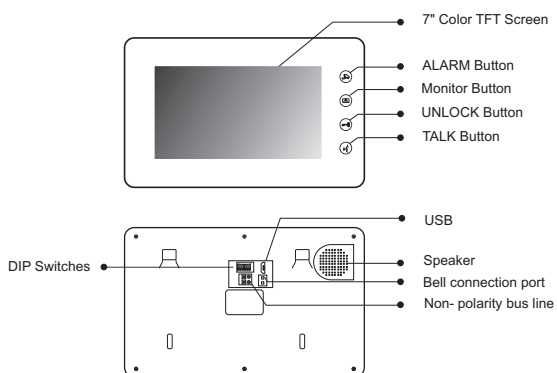

## Parts and Functions

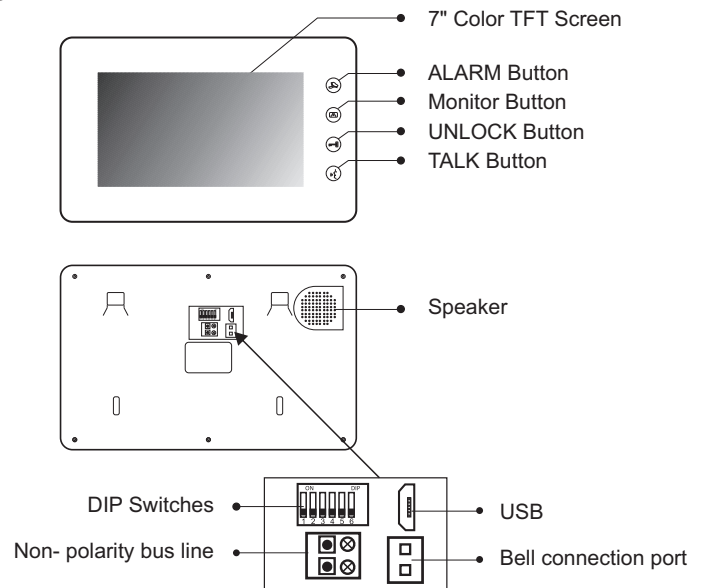
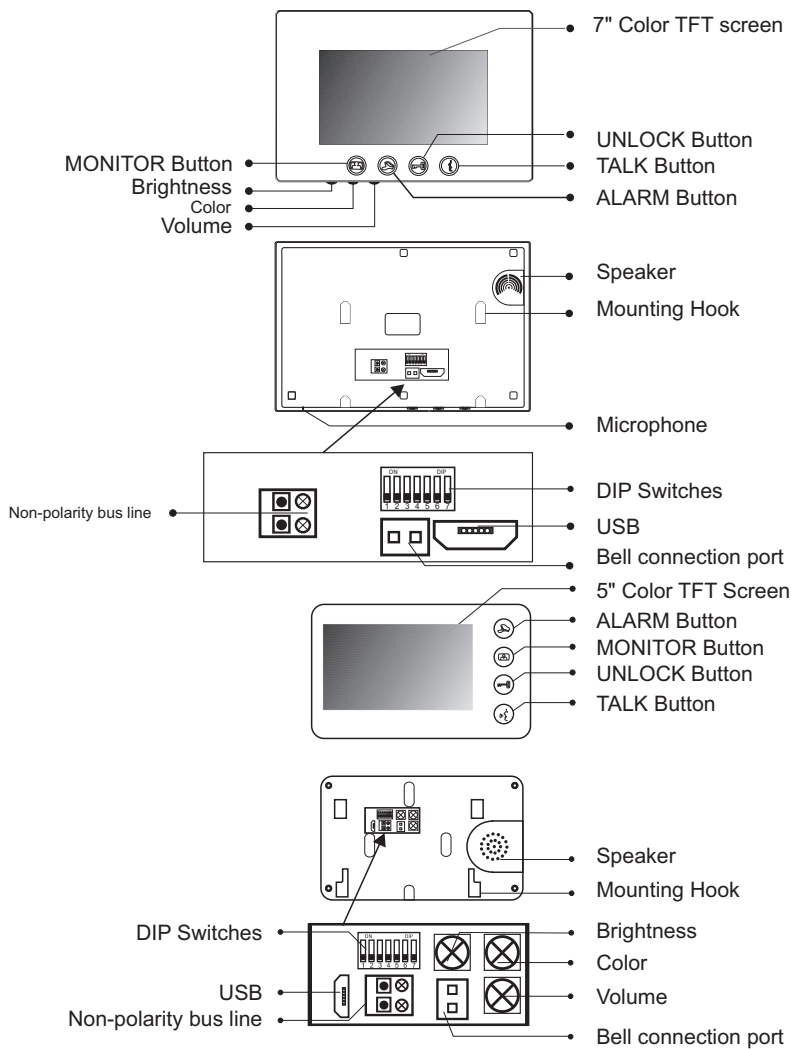

## Monitor Mounting

Using the screws to fix the Mounting Bracket on the wall. Connecting the system correctly, then hang the Monitor on the mounting bracket firmly

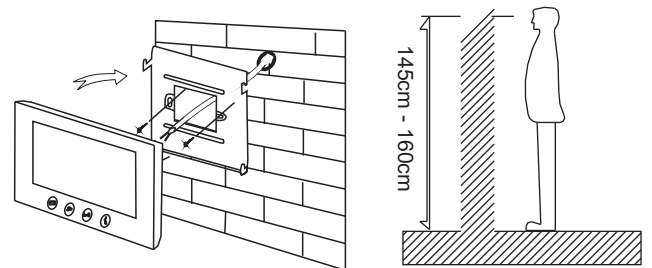

## Operation Instructions

### Answering a door call

Press **CALL** button on door station, the monitor rings, the **CALL** visitor can be seen on the monitor screen. If nobody answers the call, the screen will automatically turn off in 60 seconds.

To answer an incoming call, press **TALK** to answer, calls last for 60 seconds. **DO NOT** have to hold talk to enable voice communication. Press **TALK** again to end the conversation. If the system connects with two or more monitors, answering any monitor, the others will turn off automatically.

If there is an extra camera, during an incoming call, press **MONITOR** switch to see the view of extra camera.

## Parts and Functions

### How to set door station camera and extra camera?

Keep pressing **ALARM** button until you hear a long beep . Start setting state of multiple door stations and extra cameras . Press **MONITOR** as many times as the quantities of specific code of door state .

#### For example :

There are 3 door stations, 2 door station with extra camera, specific code of door state is 8.

Keep press **ALARM** (Long beep) – press **MONITOR 8** time – press **ALARM**



The form of the special code of the door state is as follows:

Door state	Specific code	Door state	Specific code	Door state	Specific code	Door state	Specific code
1 Door 0 Cam	Code=1	2 Door 2 Cam	Code=5	3 Door 3 Cam	Code=9	4 Door 3 Cam	Code=13
1 Door 1 Cam	Code=2	3 Door 0 Cam	Code=6	4 Door 0 Cam	Code=10	4 Door 4 Cam	Code=14
2 Door 0 Cam	Code=3	3 Door 1 Cam	Code=7	4 Door 1 Cam	Code=11		
2 Door 1 Cam	Code=4	3 Door 2 Cam	Code=8	4 Door 2 Cam	Code=12		

## Adjust the VOLUME

When idle, adjust the **VOLUME** knob to adjust the volume of the button and the volume of the bell.

Keep pressing **TALK** button until you hear a long beep, enter music choice mode. Adjust **VOLUME** rotary knob, adjust output ring-back volume.

Talkback mode, adjust **VOLUME** rotary knob, adjust talkback play volume.

## Bluetooth

Press **MONITOR** button, enter monitoring mode. At the same time the bluetooth turn on  "**ROOMBT**", use Android APP "**V-Intercom**" connecting and modify data.



# Parts and Functions

## Inner Call

User can call other apartments by pressing **ALARM** button. To start the Inner call, first you need to setup a dial number on the monitor.

### How to setup the dial number on the monitor?

Keep pressing **UNLOCK** button until you hear a long beep. Start setting 2 digit dial number.

**MONITOR** button refers to first digit 1~9

**UNLOCK** button refers to 0 / confirm.

Eg. Set the dial number to 09.

press **UNLOCK** (Long beep) – press **UNLOCK** – press **MONITOR** 9 times – press Set the dial number to 12.

press **UNLOCK**(Long beep) – press **MONITOR** 1 time – press **UNLOCK** – press **MONITOR** 2 times -press **UNLOCK**.

## User Codes (Monitor bit codes) Setup

Every room station must have an **ID**, set through the bit codes(list right)

Bit-1 to Bit-5 are used to configure the room **ID**.

Bit-6 is the line-terminal switch, set the **LAST** monitor to **ON**, otherwise set **OFF**.

You can have a Max of 4 monitor per button/code.



Monitor NOT at the end of the line

Monitor at the end of the line

Bit state	User Code	Bit state	User Code	Bit state	User Code	Bit state	User Code	Bit state	User Code	Bit state	User Code
	Code=1		Code=7		Code=12		Code=18		Code=24		Code=30
	Code=2		Code=8		Code=13		Code=19		Code=25		Code=31
	Code=3		Code=9		Code=14		Code=20		Code=26		Code=32
	Code=4		Code=10		Code=15		Code=21		Code=27		
	Code=5		Code=11		Code=16		Code=22		Code=28		
	Code=6		Code=17		Code=23		Code=29				

Power supply:

Power consumption:

Picture memory:

Wiring:

DC 24V (supplied by adaptor)

Standby 15mA, working 350mA

240pcs

2 wires, non-polarity