

6. DIP Switches Settings

Total 6 bits in the DIP switches can be configured. The switches can be modified either before or after installation.

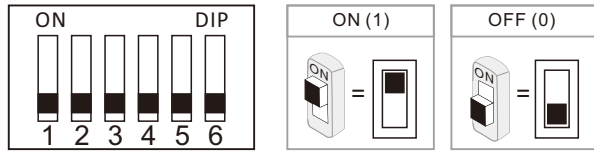

Bit-1, Bit-2 and Bit-3 are used for door station ID setting (1=on, 0=off). when multi door stations are installed in the system. these three bits must be set correctly, the first door station set to 000, the second one set to 100, the third one set to 010, the fourth one set to 110. If only one door station is installed, set to 000

- 000 - First door station
- 100 - Second door station
- 010 - Third door station
- 110 - Fourth door station

If there's extra camera connected with the system. The door station ID would be

- 000 - First door station
- 010 - Second door station
- 001 - Third door station
- 011 - Fourth door station

Bit-4 and Bit-5 is used for unlock time setting.

- 00 - 1 second (Default setting)
- 10 - 5 seconds
- 01 - 10 seconds
- 11 - 15 seconds

Bit-6 is used for connecting extra camera.

- 0 - No extra camera (Default setting)
- 1 - Connecting with extra camera

7. Electric Lock Connection

- The door lock power for a 12v DC strike (max current=250mA).
- For Electric control lock, setting the jumper SIP1 to 2-3 for a normally open lock (power ON to open);

For electromagnetic lock or magnetic lock, need set SIP1 to 1-2 for a normally closed lock (power OFF to open)

- Adjust the timer setting with Bit-4 and Bit-5 at the outdoor station (1=on, 0=off)

00-1sec, 01-5sec, 10-10sec, 11-15sec

Power ON to open

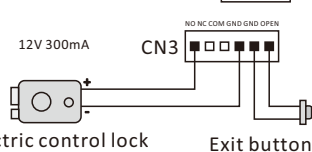
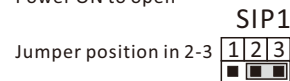

Power OFF to unlock type

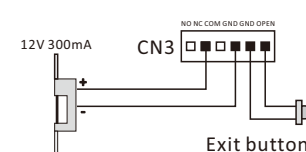
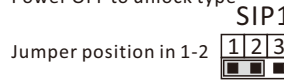

Magnetic lock

8. Electric Lock Connection

- The external power supply must be used according to the lock.
- The jumper must be taken off before connecting.
- If different unlocking time is needed, change the unlock time on door station by modifying the BIT-4 and BIT-5.

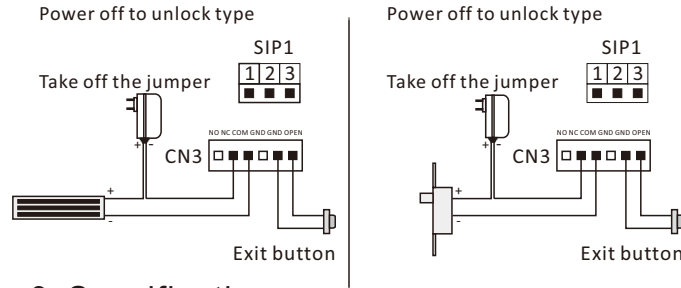

9. Specification

Power supply: DC 24V

Power Consumption: 1W in standby, 5W in working

Unlock Power output: 12Vdc, 250mA

Unlock timing: 1s, 5s, 10s, 15s

Working Temperature: -20°C~ +55°C

10. User Instructions of RFID Access Control

1) Using IC card Encryption Mode (Factory Default):

When disconnected Encryot stitch, means IC card encryption mode. When swiping card unlocking, IC card should be with corresponding password. This function prevent copy IC card by others.

2) Using IC Card No Encryption Model:

When connected Encryot stitch, means IC card no encryption mode. When swiping card unlocking, unlocking only with corresponding IC card number. After copy IC card, use the copy card unlocking.

3) Record Manage Card:

When connected Manage stitch, hearing one beep every second get into record manage card mode, swiping a new IC card, manage card recording successfully when hearing a long beep, cut off the Manage stitch to ending at last.

4) Delete a User Card:

Connecting Delete stitch, hearing a beep, swiping the user card which needs to delete in 10 seconds. Hearing three times short beep, delete successfully, cut off the Delete stitch to ending at last.

5) Formatting All The Cards:

Connecting Format stitch, hearing a beep begin to formatting, hearing a beep after 5 seconds, all the manage cards and user cards will be deleted, formatting finished, cut off the Format stitch to ending at last.

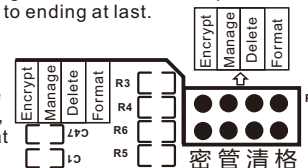

Door Station

2-wire Door Station

Quick Installation Guide



Dimension: 195(H)×130(W)×52(D)mm

Embedded Dimension: 185(H)×110(W)×33(D)mm

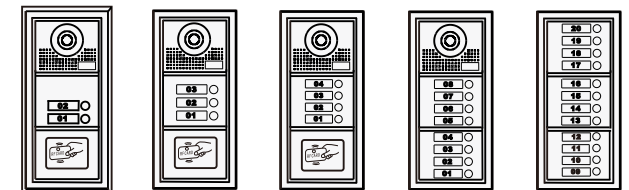

Dimension: 276(H)×130(W)×52(D)mm

Embedded Dimension: 270(H)×110(W)×33(D)mm

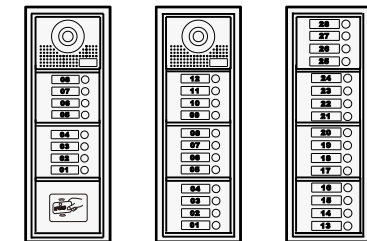

Dimension: 360(H)×130(W)×52(D)mm

Embedded Dimension: 350(H)×110(W)×33(D)mm

Please read this manual carefully before using the product .

1. Parts and Functions

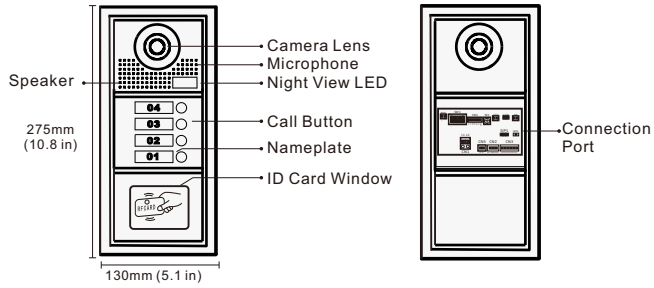

2. Terminal Description

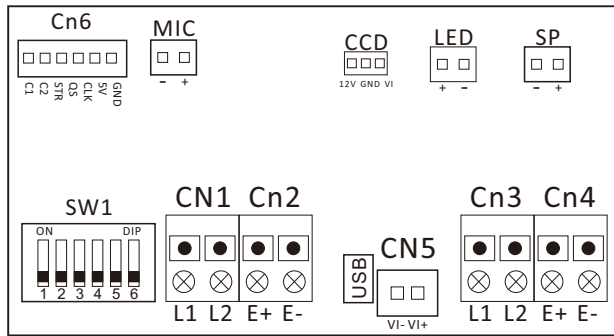

- MIC: Microphone connection port
- SW1: DIP switches for system configurations.
- CN4: Call button module connection port
- W1: Volume adjustor
- LED: Night vision light connection port
- CCD: Camera module connection port
- SP: Speaker connection port
- CN1: (L1, L2) non-polarity bus line
- CN5: Extra camera connection port
- Cn2: Card reader module connection port
- SIP1: Door lock jumper

3. Place Name Label

Press down and move left to open the transparent nameplate cover. Then insert the name paper and put the cover back.

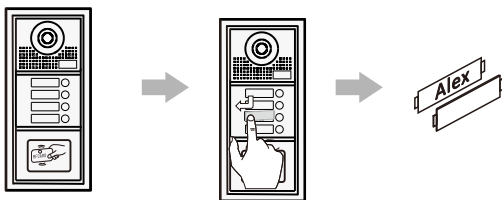

4. Mounting

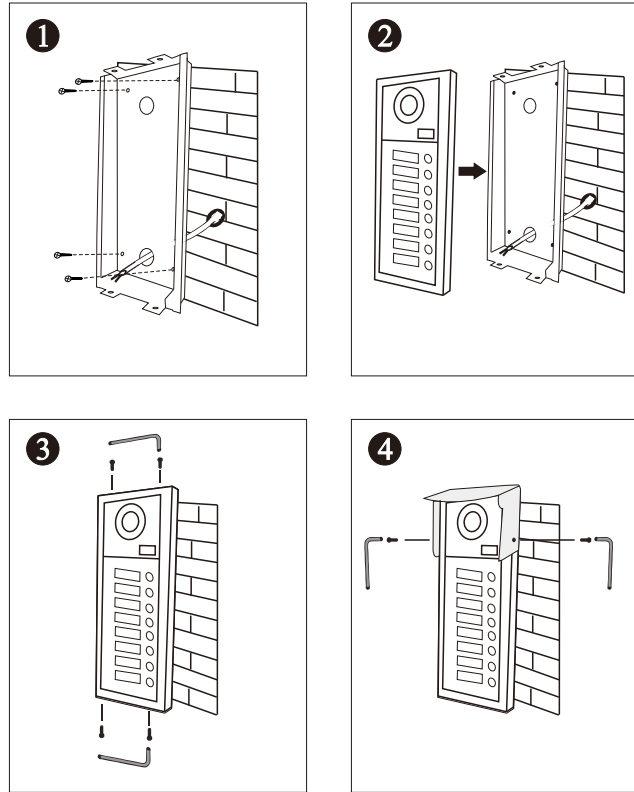

Installation with expanding panel

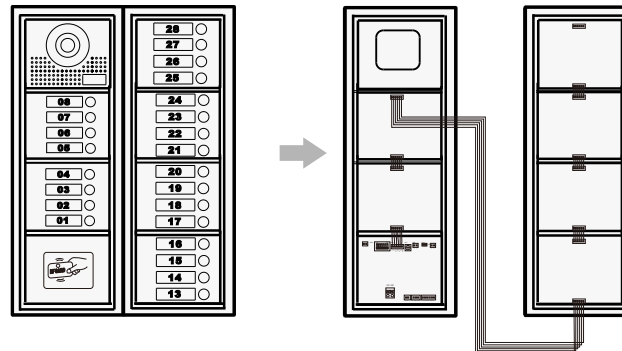

5. System Connection

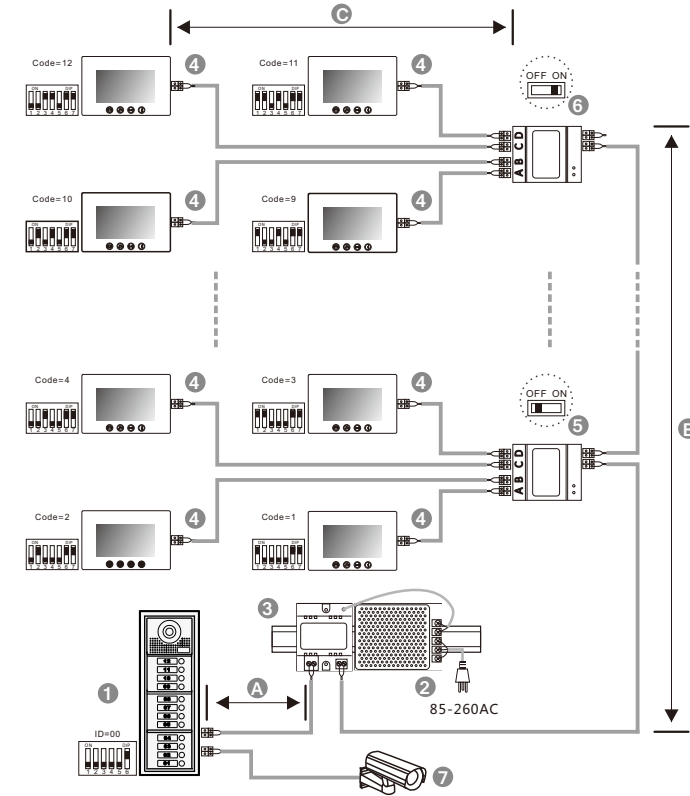

When monitor quantity < 20

Cable Usage	A	B	C
Parallel cable 2X0.75mm ²	60	60	30
Parallel cable 2X1mm ²	80	80	40

When monitor quantity > 20

Cable Usage	A	B	C
Parallel cable 2X1mm ²	60	60	30
Parallel cable 2X1.5mm ²	80	80	40

[1]: Door station, when there is only one Door station, the DIP bit-1 bit-2 and bit-3 should be set to 000.

[2]: Power supply, MUST be installed side by side with Power Separator.

[3]: Power Separator, MUST be installed side by side with Power supply.

[4]: Monitor, each one with an unique User Code, note that all the bit-6 of the DIP should be set to 1(ON) in this case.

[5]: Video distributor set switch to OFF unless at the end of the line.

[6]: Video distributor set switch to ON at the end of the line.

[7]: Extra camera.